



ROTARY SHAFTS - ONE STEPPED END TYPE-

回転軸 -D公差 h9(みがき棒)/h7(研磨棒)/g6(研磨棒)- 一片端段付タイプ

■各用途によってh9(みがき棒)、h7(研磨棒)、g6(研磨棒)を選択できます。またh9(みがき棒)では、P部公差にh7・g6をそれぞれ選択いただけます。



Table with columns: Type, D, P, 材質, 表面処理. Lists various shaft types like NSFRMHP, SFRMHP, PSFRMHP, SSFRMHP, NSFRMGP, SFRMGP, PSFRMGP, SSFRMGP, NSFRHP, SFRHP, PSFRHP, SSFRHP, NSFRFP, SFRFP, PSFRFP, SSFRFP, HFRP.

Table with columns: D, P, h9(みがき棒), h7(研磨棒), g6(研磨棒). Shows tolerance ranges for different diameters.

①D部面粗度 h9(みがき棒)はRz, h7(研磨棒)・g6(研磨棒)はRaになります。 ②止め輪溝付タイプはP.885をご参照下さい。

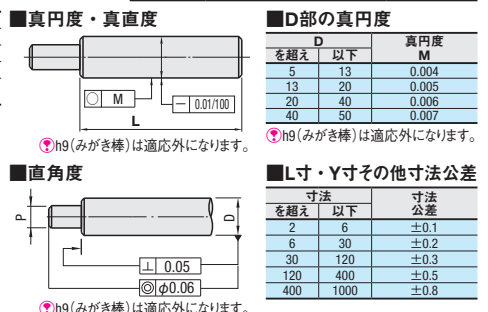
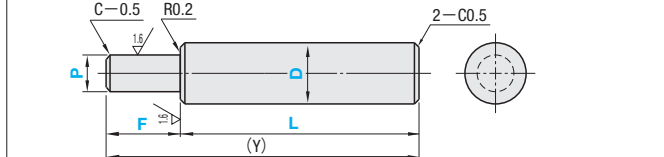

Table with columns: Type, D, L, F, P, (Y) max. Lists shaft types and their dimensions.

Table with columns: Type, D, L, F, P, (Y) max. Lists shaft types and their dimensions.

Table with columns: Type, D, L, F, P, (Y) max. Lists shaft types and their dimensions.

Order information including delivery date (2 days), price list, and contact details.



Table with columns: D, L50.1, L100.1, L150.1, L200.1, L300.1, L400.1, L600.1, L800.1. Lists shaft types and their dimensions.

Table with columns: D, L50.1, L100.1, L150.1, L200.1, L300.1, L400.1, L600.1, L800.1. Lists shaft types and their dimensions.

Table with columns: D, L50.1, L100.1, L150.1, L200.1, L300.1, L400.1, L600.1, L800.1. Lists shaft types and their dimensions.

Table with columns: D, L50.1, L100.1, L150.1, L200.1, L300.1, L400.1, L600.1, L800.1. Lists shaft types and their dimensions.

Table with columns: D, L50.1, L100.1, L150.1, L200.1, L300.1, L400.1, L600.1, L800.1. Lists shaft types and their dimensions.

Table with columns: D, L50.1, L100.1, L150.1, L200.1, L300.1, L400.1, L600.1, L800.1. Lists shaft types and their dimensions.

Table with columns: D, L50.1, L100.1, L150.1, L200.1, L300.1, L400.1, L600.1, L800.1. Lists shaft types and their dimensions.

Table with columns: D, L50.1, L100.1, L150.1, L200.1, L300.1, L400.1, L600.1, L800.1. Lists shaft types and their dimensions.

Table with columns: D, L50.1, L100.1, L150.1, L200.1, L300.1, L400.1, L600.1, L800.1. Lists shaft types and their dimensions.

Alteration追加加工 SFRMGP10 - 200 - F10 - P5 - KFC10-G10-AG90

Table with columns: 1ヶ所, 2ヶ所, 1ヶ所(4ヶ所目用), 段部Pキー溝(端面O地点), 段部Pキー溝(位置指定), 段部Pキー溝複数ヶ所. Details keyway specifications.

Table with columns: 1ヶ所, 2ヶ所, 平面取り, 角度指定2面取り, 段部平面取り, D部, 止め輪溝追加加工, 段部. Details surface and chamfer specifications.

Table with columns: スリットカム用溝, L寸法公差変更, スパナ溝, 同軸度変更, D部面取り, C面取, 輪変更, 段部P部面取り. Details groove and concentricity specifications.

12回転軸